

Map Referred to in The Walsall Metropolitan Borough Council (Moat Street and Villiers Street) Compulsory Purchase Order 2023

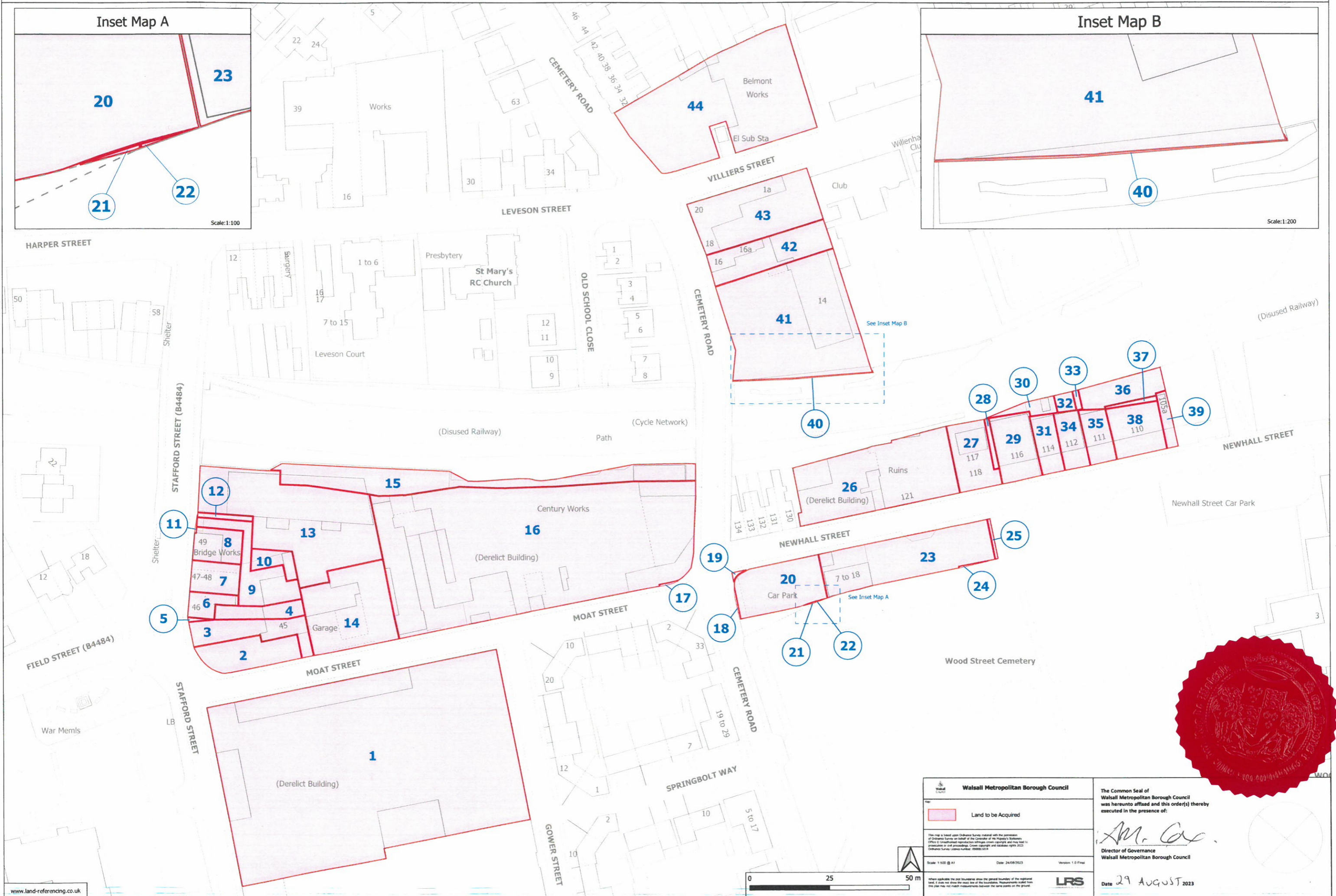
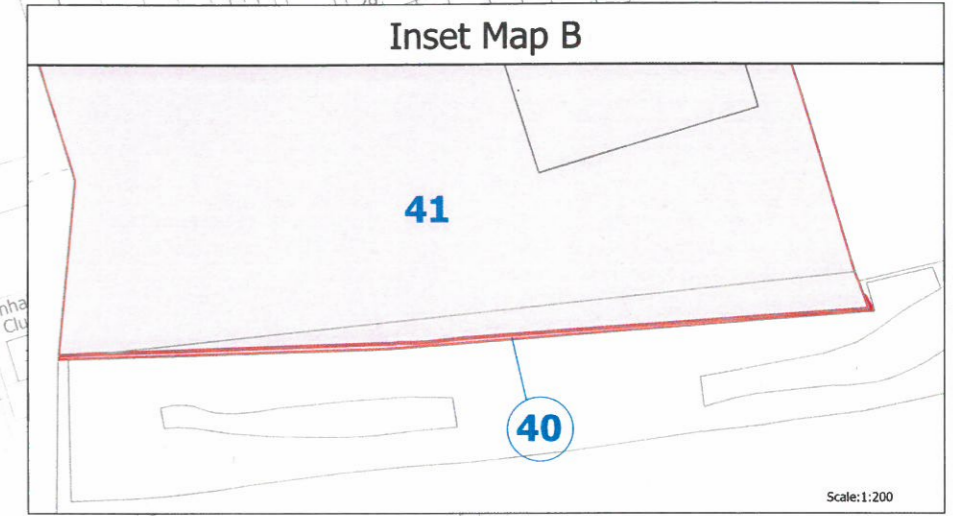
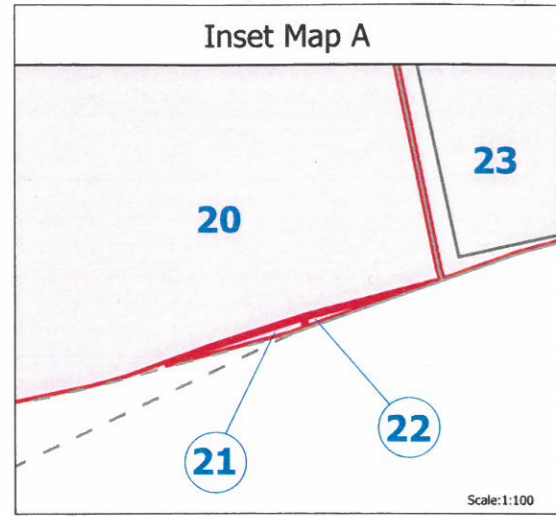

<p>Walsall Metropolitan Borough Council</p>		<p>The Common Seal of Walsall Metropolitan Borough Council was hereunto affixed and this order(s) thereby executed in the presence of:</p> <p><i>Mr. Cox</i></p> <p>Director of Governance Walsall Metropolitan Borough Council</p> <p>Date 29 August 2023</p>
<p>Land to be Acquired</p>		
<p><small>This map is based upon Ordnance Survey material with the permission of Ordnance Survey on behalf of the Controller of the King's Stationery Office. It is unauthorised reproduction without express copyright and may lead to prosecution in civil proceedings. Crown copyright and database rights 2023. Ordnance Survey Licence number: 000081014</small></p>		<p>Scale: 1:500 @ A1 Date: 24/08/2023 Version: 1.0 Final</p> <p><small>Where applicable the past boundaries show the general boundary of the registered land. It does not show the exact line of the boundaries. Measurements taken from this plan may not match measurements taken on the ground.</small></p>
<p>0 25 50 m</p>		